



**16 Wickets End, Shenley
Hertfordshire WD7 9EX
Guide Price £565,000**

Offered for sale CHAIN FREE is this detached three bedroom property located at the top end of Porters Park. Located on a popular close it is within short walking distance to local amenities and over the road to Shenley Park. Whilst in need of some updating this is a wonderful opportunity to make this property your own and with huge potential, this is a blank canvas to put your own stamp on your new home.

Accommodation comprises three bedrooms and family bathroom, two reception rooms - a spacious living room and dining room, fitted kitchen and downstairs WC.

The property benefits from generous living space, has a c40' rear garden and a detached garage to the side of the property with driveway for two cars. There is also scope for an extension to the rear of the property (stpp).

EPC Rating Band C,



Entrance Hall

WC

Lounge

16'9 x 15'1 at max points (5.11m x 4.60m at max points)

Dining Room

8'10 x 8 (2.69m x 2.44m)

Kitchen

8'10 x 6'6 (2.69m x 1.98m)

Landing

Bedroom One

13'5 into wardrobes x 8'11 (4.09m into wardrobes x 2.72m)

Bedroom Two

12'2 x 8'5 (3.71m x 2.57m)

Bedroom Three

8'10 x 6'5 (2.69m x 1.96m)

Bathroom

Rear Garden

Garage

17'10 x 8'3 (5.44m x 2.51m)

With driveway for 2 cars in front.

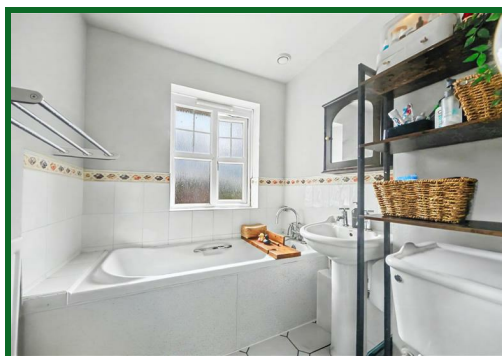
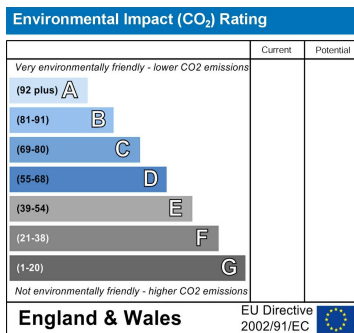
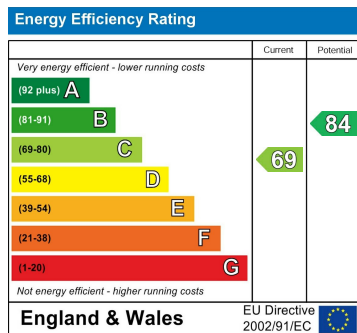

20 Andrew Close, Shenley | Herts WD7 9LP
 Tel: 01923 856464 | Email: info@shenleyestates.com



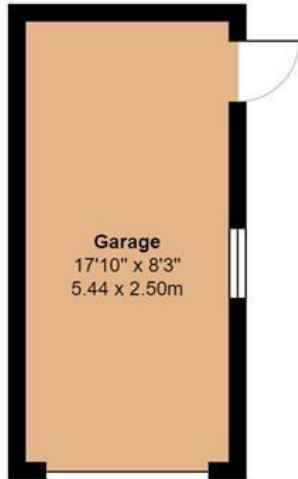

'Your *home* is our business'

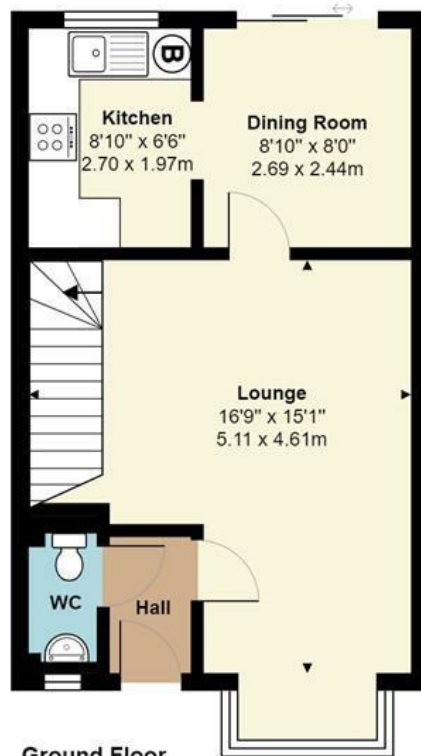

Ground Floor
Area: 419 ft² ... 39.0 m²

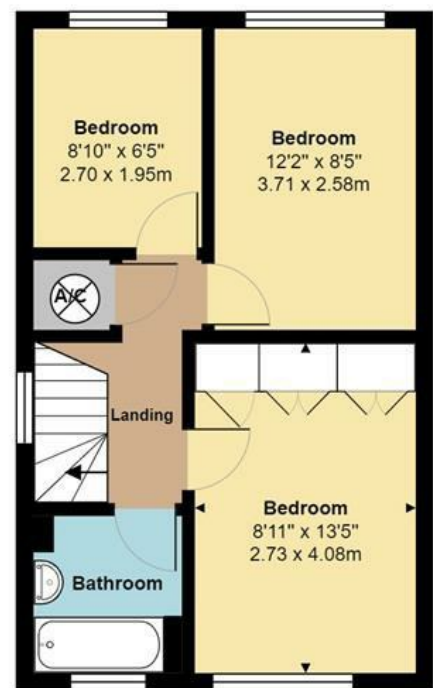

First Floor
Area: 404 ft² ... 37.6 m²

Total Area: 824 ft² ... 76.6 m² (Excluding Garage)
All measurements are approximate and for display purposes only



20 Andrew Close, Shenley | Herts WD7 9LP
Tel: 01923 856464 | Email: info@shenleyestates.com

